

# Tecno Truss

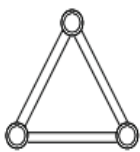

Tralicci in Alluminio



## Le Serie



La gamma di tralicci disponibile è compatta e va dalle piccole truss per arredamento o sospensione dell' illuminazione in negozi, spazi espositivi e fiere, alle classiche truss a sezione piatta, triangolare e quadrata. Tutti i tralicci, ad eccezione della Mini, hanno il sistema di bloccaggio professionale rapido mediante i connettori conici con spina e coppiglia. Sono realizzati in lega di alluminio T6061, con tubi principali e diagonali di spessori 2 mm.

La serie EFT è il classico traliccio a sezione piatta ma di grande robustezza, grazie al lato da 290 mm, con tubi principali da 50 mm/ 2 mm di spessore e tubi diagonali da 20 mm/ 2 mm spess., realizzata in lega T6061, con giunzioni mediante connettori conici, spine e coppiglie.

La serie MINI, disponibile in alluminio o verniciata nera, è un piccolo traliccio di sezione quadrata di lato 100 mm, realizzata in lega T6061, ideale per la realizzazione di arredamenti negozi, sospensione piccoli fari da vetrina o di arredo, spazi espositivi. E' completato da una serie di accessori che permettono di realizzare qualsiasi forma geometrica. Il fissaggio è tramite dado e bullone.

La serie ETT, di sezione triangolare, è disponibile con lati da 290 mm, è realizzata con lega T6061 e tubi da 35 mm/1,5mm di spessore. La versione ETT è compatibile con i tralicci triangolari più diffusi sul mercato.

La serie EST, di sezione quadrata, è disponibile con lati da 290 mm, realizzata con lega T6061 e tubi principali da 50 mm/2 mm di spessore. La versione EST è compatibile con i tralicci triangolari più diffusi sul mercato.



## MT-100

### DATI TECNICI:

Tubo principale: 20x2 mm

Diagonali: 10x2 mm

Alluminio: T6061

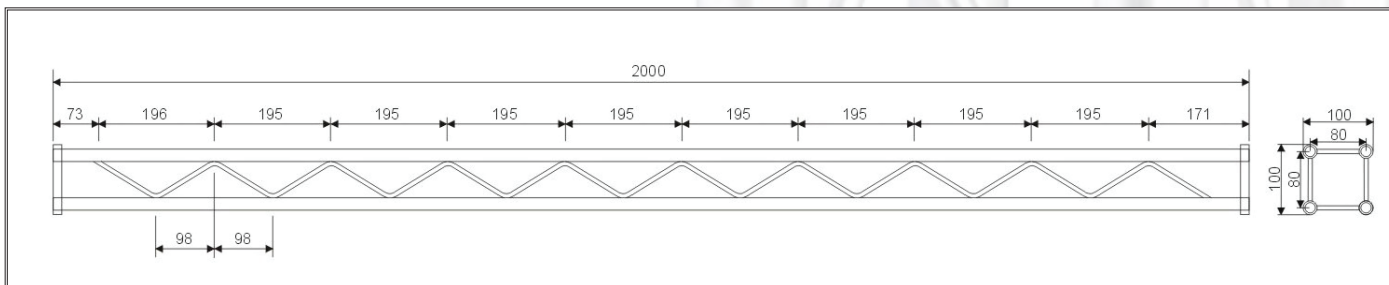
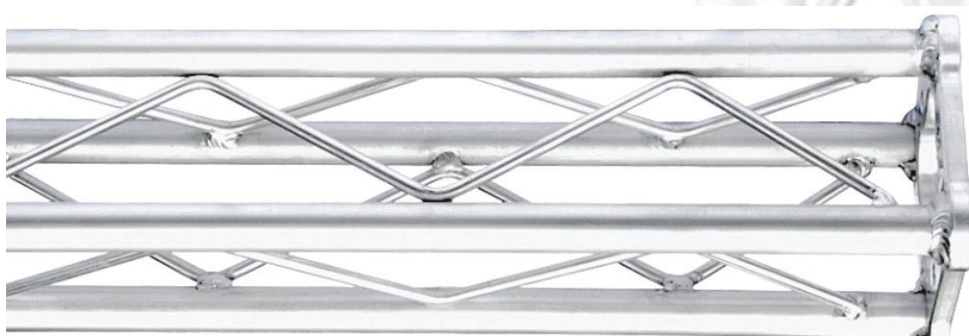

MODEL	DESCRIPTION	DIMENSIONS	DIAMETER/THICKNESS	LENGTH
MT-100	MINI TRUSS	100 x 100MM	20 x 2MM	500MM
MT-100	MINI TRUSS	100 x 100MM	20 x 2MM	1000MM
MT-100	MINI TRUSS	100 x 100MM	20 x 2MM	1500MM
MT-100	MINI TRUSS	100 x 100MM	20 x 2MM	2000MM
MT-100	MINI TRUSS	100 x 100MM	20 x 2MM	2500MM
MT-100	MINI TRUSS	100 x 100MM	20 x 2MM	3000MM

	2M	3M	4M	5M	6M	7M	8M	9M	10M	11M	12M
CENTRE POINT LOAD(KG)	408	302.2	229.6	208.8	173.8	142.8	121.2	100.8	85.6	76.6	70.8
DEFLECTION(MM)	5	10	18	32	46	60	76	90	105	125	146
SYMMETRICAL LOAD(KG)	472.6	373.4	275.6	221.8	186.6	165.4	145	129.6	113.4	100.4	88.2
DEFLECTION(MM)	4	8	14	22	32	45	59	75	90	106	121



## EFT-290

### DATI TECNICI:



Tubo principale: 50x2 mm

Diagonali: 20x2 mm

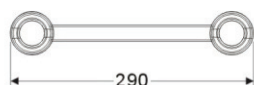
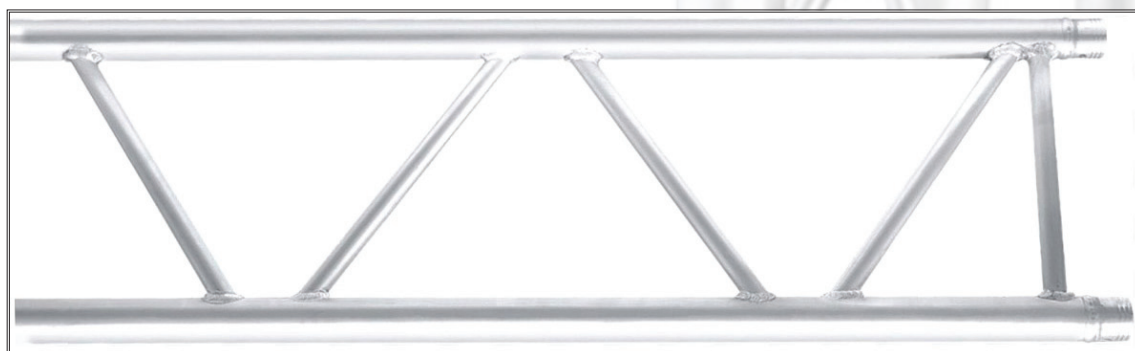
Alluminio: T6061



MODEL	DESCRIPTION	DIMENSIONS	DIAMETER/THICKNESS	LENGTH
EFT-290-2	FLAT TRUSS	290MM	50 x 2MM	500MM
EFT-290-2	FLAT TRUSS	290MM	50 x 2MM	1000MM
EFT-290-2	FLAT TRUSS	290MM	50 x 2MM	1500MM
EFT-290-2	FLAT TRUSS	290MM	50 x 2MM	2000MM
EFT-290-2	FLAT TRUSS	290MM	50 x 2MM	2500MM
EFT-290-2	FLAT TRUSS	290MM	50 x 2MM	3000MM

	1M	2M	3M	4M	5M	6M	7M	8M	9M	10M	11M	12M
 CENTRE POINT LOAD(KG)	1440	1190	1110	820	752	700	699	683	640	598	530	494.2
DEFLECTION(MM)	2.5	5.1	8.6	11.8	16.5	22.6	31.7	41.3	51.3	63.3	71.7	84.4
 SYMMETRICAL LOAD(KG)	1362(2)	1348(4)	1218(6)	1076(8)	1027(10)	960(12)	882(14)	840(16)	788(18)	740(20)	704(22)	672(24)
DEFLECTION(MM)	1.8	3.3	5.0	8.0	10.7	14.2	19.8	25.3	31.7	40.0	48.2	57.8

# ETT-290

**DATI TECNICI:**

Tubo principale: 50x2 mm

Diagonali: 20x2 mm

Alluminio: T6061

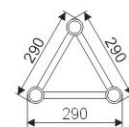
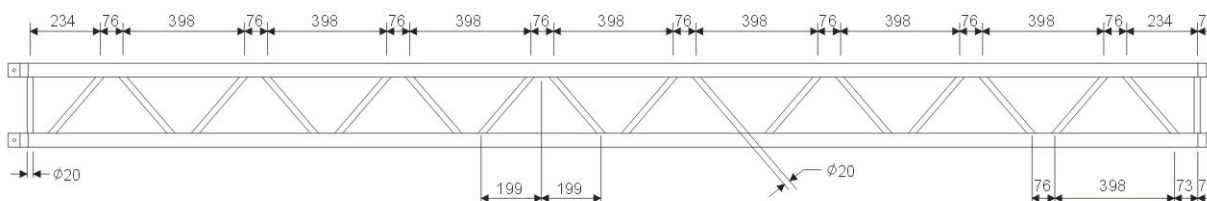

MODEL	DESCRIPTION	DIMENSIONS	DIAMETER/THICKNESS	LENGTH
ETT-290-2	TRIANGLE TRUSS	290 x 290MM	50 x 2MM	500MM
ETT-290-2	TRIANGLE TRUSS	290 x 290MM	50 x 2MM	1000MM
ETT-290-2	TRIANGLE TRUSS	290 x 290MM	50 x 2MM	1500MM
ETT-290-2	TRIANGLE TRUSS	290 x 290MM	50 x 2MM	2000MM
ETT-290-2	TRIANGLE TRUSS	290 x 290MM	50 x 2MM	2500MM
ETT-290-2	TRIANGLE TRUSS	290 x 290MM	50 x 2MM	3000MM

	2M	3M	4M	5M	6M	7M	8M	9M	10M	11M	12M	13M
<b>CENTRE POINT LOAD(KG)</b>	968.4	696.3	489.2	433.2	348.5	292.4	228.1	169.5	165	135.8	114.9	102.6
<b>DEFLECTION(MM)</b>	3	10	15	23	32	41	51	62	73	82	93	102
<b>SYMMETRICAL LOAD(KG)</b>	1088.4	917.4	782.2	721	556.3	450.4	430.7	398.2	360.5	323.5	278.1	259.7
<b>DEFLECTION(MM)</b>	4	11	17	28	37	48	60	72	83	95	108	119



## EST-290

### DATI TECNICI:

Tubo principale: 50x2 mm

Diagonali: 20x2 mm

Alluminio: T6061

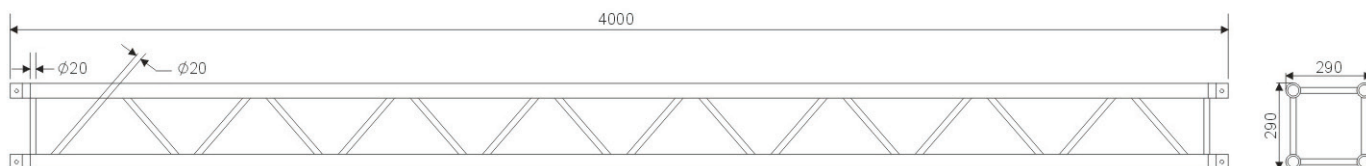
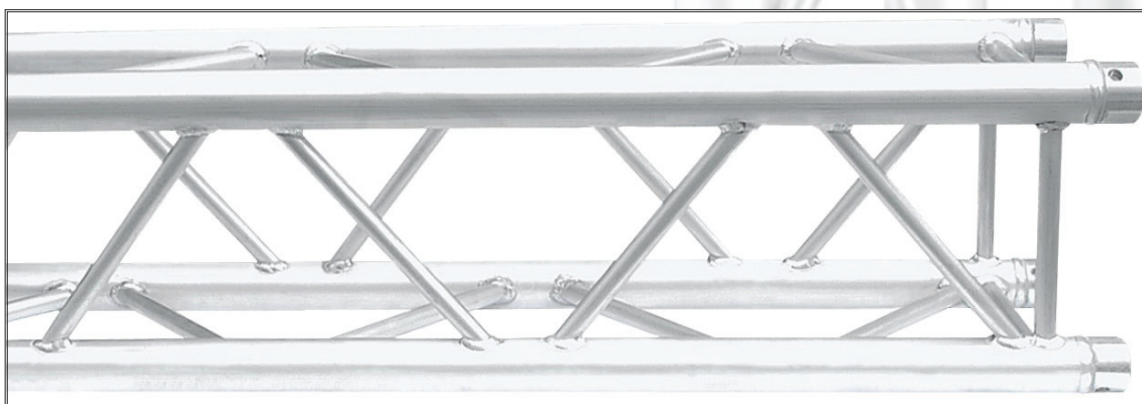

MODEL	DESCRIPTION	DIMENSIONS	DIAMETER/THICKNESS	LENGTH
EST-290-2	SQUARE TRUSS	290 x 290MM	50 x 2MM	500MM
EST-290-2	SQUARE TRUSS	290 x 290MM	50 x 2MM	1000MM
EST-290-2	SQUARE TRUSS	290 x 290MM	50 x 2MM	1500MM
EST-290-2	SQUARE TRUSS	290 x 290MM	50 x 2MM	2000MM
EST-290-2	SQUARE TRUSS	290 x 290MM	50 x 2MM	2500MM
EST-290-2	SQUARE TRUSS	290 x 290MM	50 x 2MM	3000MM

	2M	3M	4M	5M	6M	7M	8M	9M	10M	11M	12M	13M
CENTRE POINT LOAD(KG)	1311.1	1002.3	704.7	649.4	501.1	420.7	405.1	309	302.2	235.5	216.8	175
DEFLECTION(MM)	2	8	14	22	32	45	52	59	66	68	74	87
SYMMETRICAL LOAD(KG)	1473.6	1319.8	1125.4	1037.1	800.2	648.2	619	573	518.5	465.3	400	373.6
DEFLECTION(MM)	2	7	13	18	24	36	43	49	59	68	75	82

## CIRCOLARI

MINIMUM DIA: 1MT



MTC-100 - Traliccio circolare, sezione quadrata, lato 100 mm.

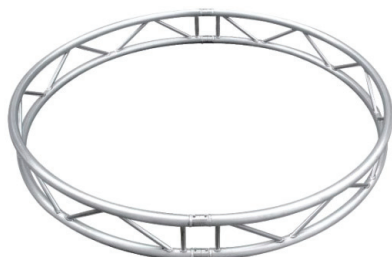

FCT-290 - Traliccio circolare, sezione flat, lato 290 mm.

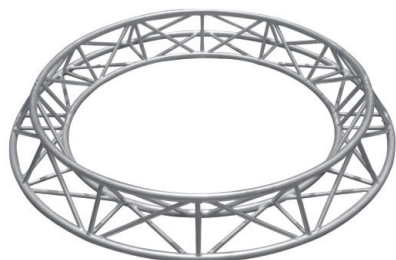

TCT-290 - Traliccio circolare, sezione triangolare, lato 290 mm.

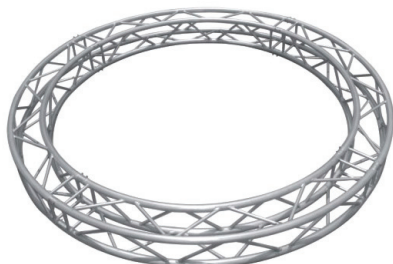

SCT-290 - Traliccio circolare, sezione quadrata, lato 290 mm.

### TRALICCI NON STANDARD

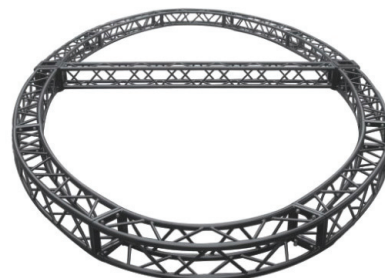
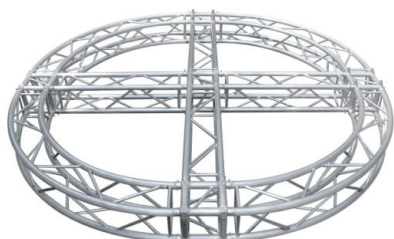



**ANGOLI MT**

**MTB-1**  
0-90 DEGREE CORNER



**MTB-2**  
0-180 DEGREE CORNER



**MTB-3**  
0-280 DEGREE CORNER

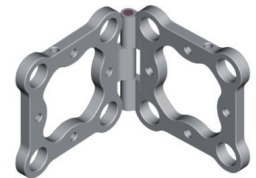

**MTB-4**  
SIX SIDE BOX WITH M8 SCREW TAP

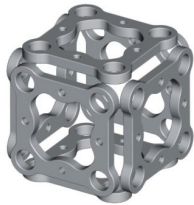



**ANGOLI EFT**

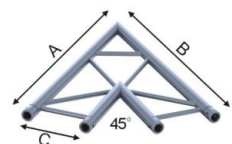

	A	B	C
TCF-2901	1000	1000	290

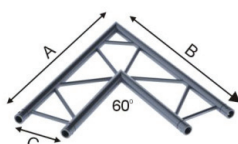

	A	B	C
TCF-2902	1000	1000	290

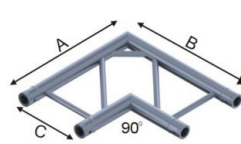

	A	B	C
TCF-2903	500	500	290

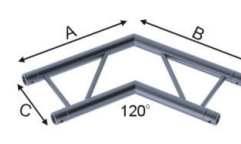

	A	B	C
TCF-2904	500	500	290

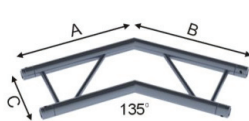

	A	B	C
TCF-2905	500	500	290

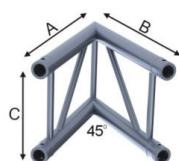

	A	B	C
TCF-2906	1000	1000	290

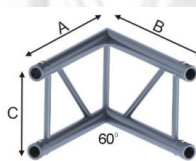

	A	B	C
TCF-2907	1000	1000	290

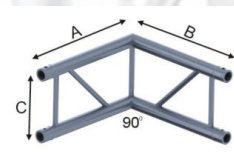

	A	B	C
TCF-2908	500	500	290

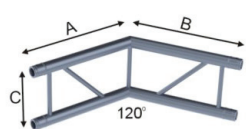

	A	B	C
TCF-2909	500	500	290

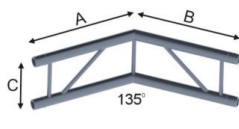

	A	B	C
TCF-2910	500	500	290

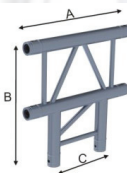

	A	B	C
TCF-2911	500	500	290

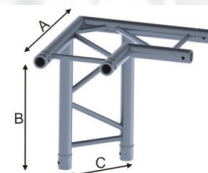

	A	B	C
TCF-2912	500	500	290

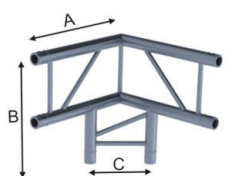

	A	B	C
TCF-2913	500	500	290

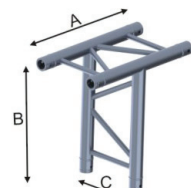

	A	B	C
TCF-2914	500	500	290

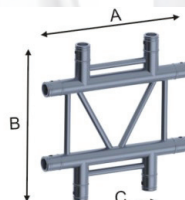

	A	B	C
TCF-2918	500	500	290

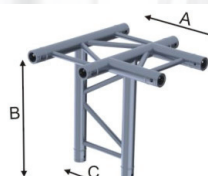

	A	B	C
TCF-2915	500	500	290

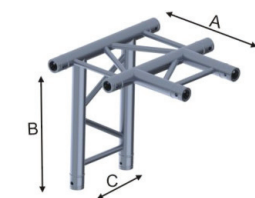

	A	B	C
TCF-2916	500	500	290

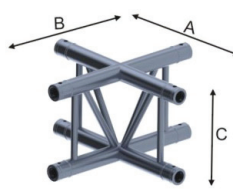

	A	B	C
TCF-2917	500	500	290

**ANGOLI ETT**

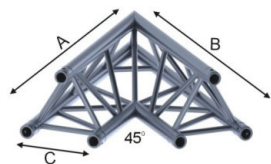

	A	B	C
TCT-2901	1000	1000	290

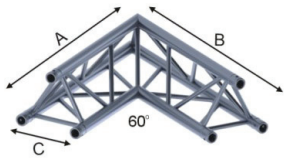

	A	B	C
TCT-2902	1000	1000	290

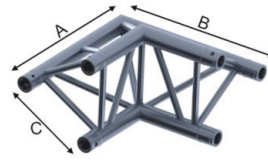

	A	B	C
TCT-2903	500	500	290



	A	B	C
TCT-2904	500	500	290

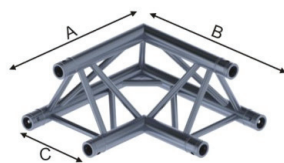

	A	B	C
TCT-2905	500	500	290

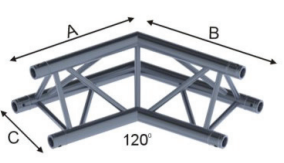

	A	B	C
TCT-2906	500	500	290

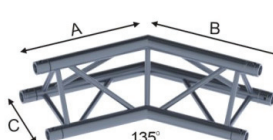

	A	B	C
TCT-2907	500	500	290

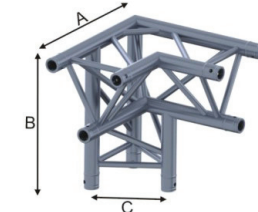

	A	B	C
TCT-2908	500	500	290

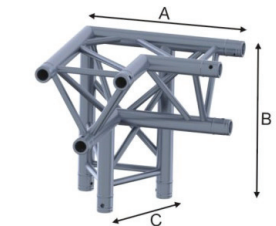

	A	B	C
TCT-2909	500	500	290

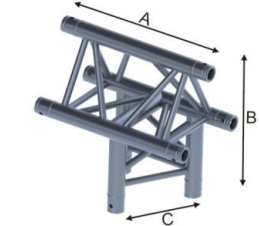

	A	B	C
TCT-2910	500	500	290

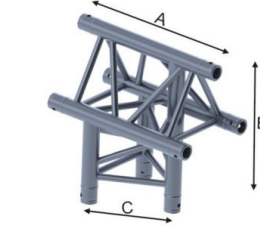

	A	B	C
TCT-2911	500	500	290

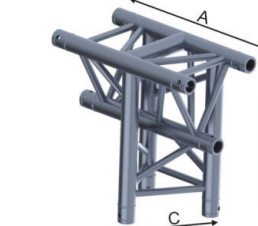

	A	B	C
TCT-2912	500	500	290

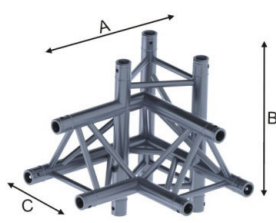

	A	B	C
TCT-2916	500	500	290

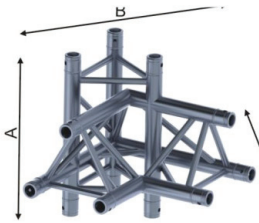

	A	B	C
TCT-2917	500	500	290

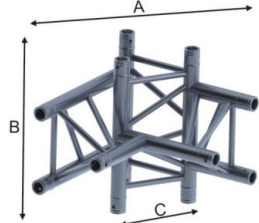

	A	B	C
TCT-2918	500	500	290

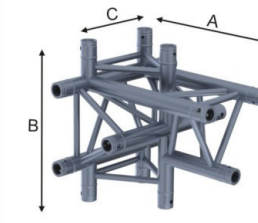

	A	B	C
TCT-2919	500	500	290

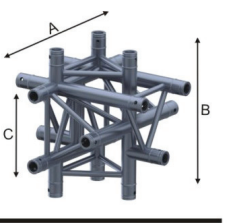

	A	B	C
TCT-2920	500	500	290

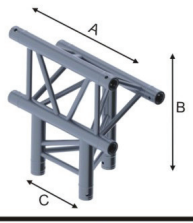

	A	B	C
TCT-2921	500	500	290

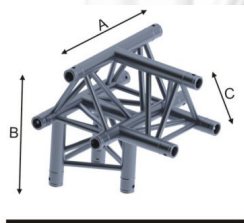

	A	B	C
TCT-2922	500	500	290

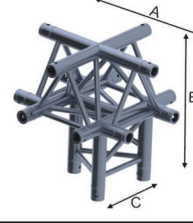

	A	B	C
TCT-2923	500	500	290

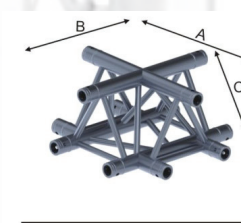

	A	B	C
TCT-2924	500	500	290

**ANGOLI EST**

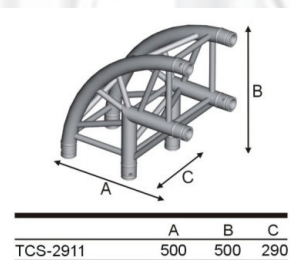
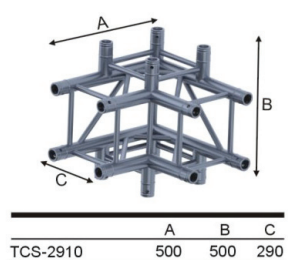
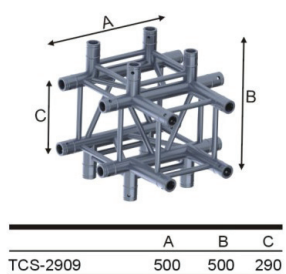
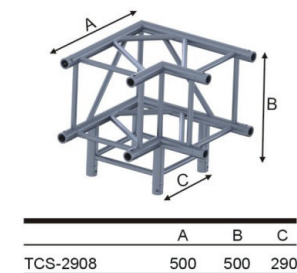
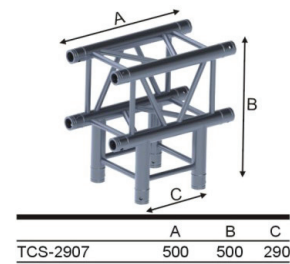
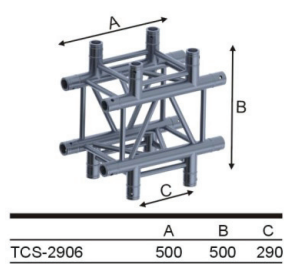
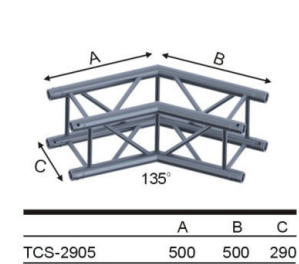
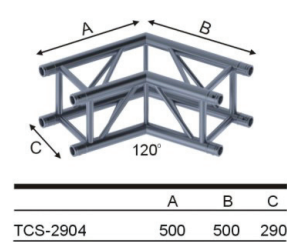
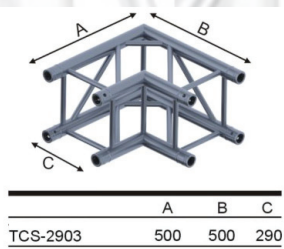
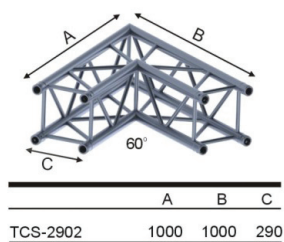
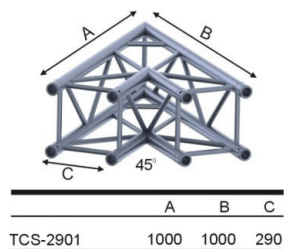



## ACCESSORI

### ACCESSORI SERIE MT-100

**MTBP-1**

ALUMINIUM BASE 590X290MM

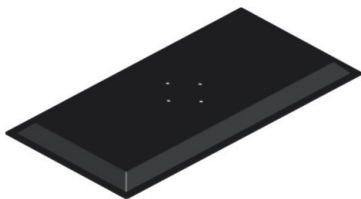

**MTCP-1**

LIGHTING CLAMP



**MTS-1**

CONNECTOR SCREW



### ACCESSORI SERIE EFT-290

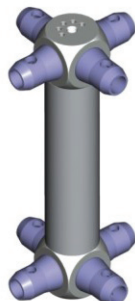

**ESB-290**

### ACCESSORI SERIE ETT-290



**TBP-290-10**

BASE PLATE

DIMENSIONS :290X290X10MM



**ACCESSORI**

ACCESSORI SERIE EST-290



**BP-290-10**  
BASE PLATE  
DIMENSIONS :290X290X10MM

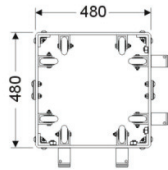
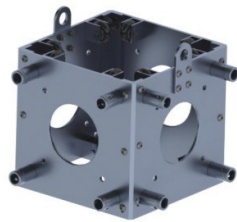

**BL-290B**  
BEAM TRUSS ARE SUIT FOR MULTI WAYS  
290MM / 390MM / 400MM

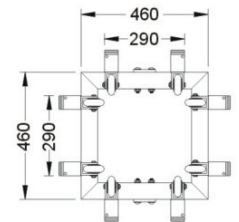
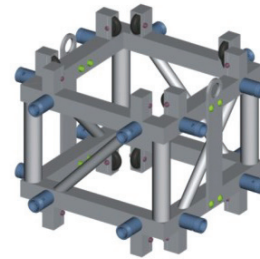

**BL290A**  
BEAM TRUSS : 290MM  
ONLY FOR SINGLE WAY

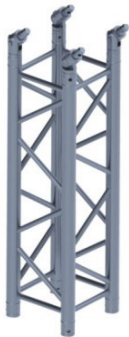

**HCC-290-2**  
HINGE 290MM/50MM/2MM/1MT

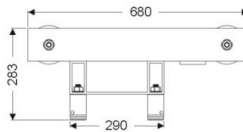

**TFE-290**  
TOP FRAME FOR MOTOR HOIST

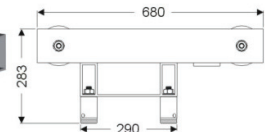
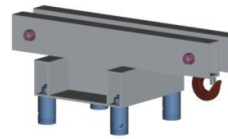

**TFM-290**  
TOP FRMAE FOR MANUAL HOIST

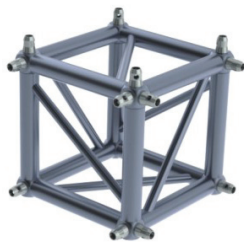

**BS-290**



**BPS-290**

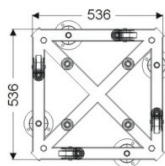

**BPS-290L**  
SUPPORTING LEGS



**ACCESSORI**

**FLYING TRUSS FRAME**

FTF-290



**TF-001-60**

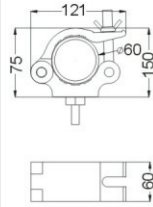

**TF-002-290**

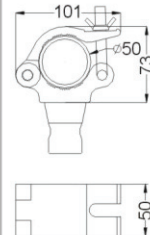

**TF-006**

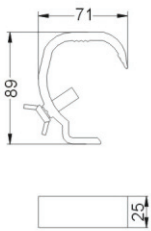

**TF-007-290**

HIGNE ACCESSORIES FOR EST TRUSS



**TF-004-5060**

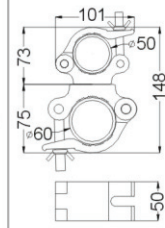

**MANUAL HOIST**

1000KG/2000KG



**DH-500**



GALLERY

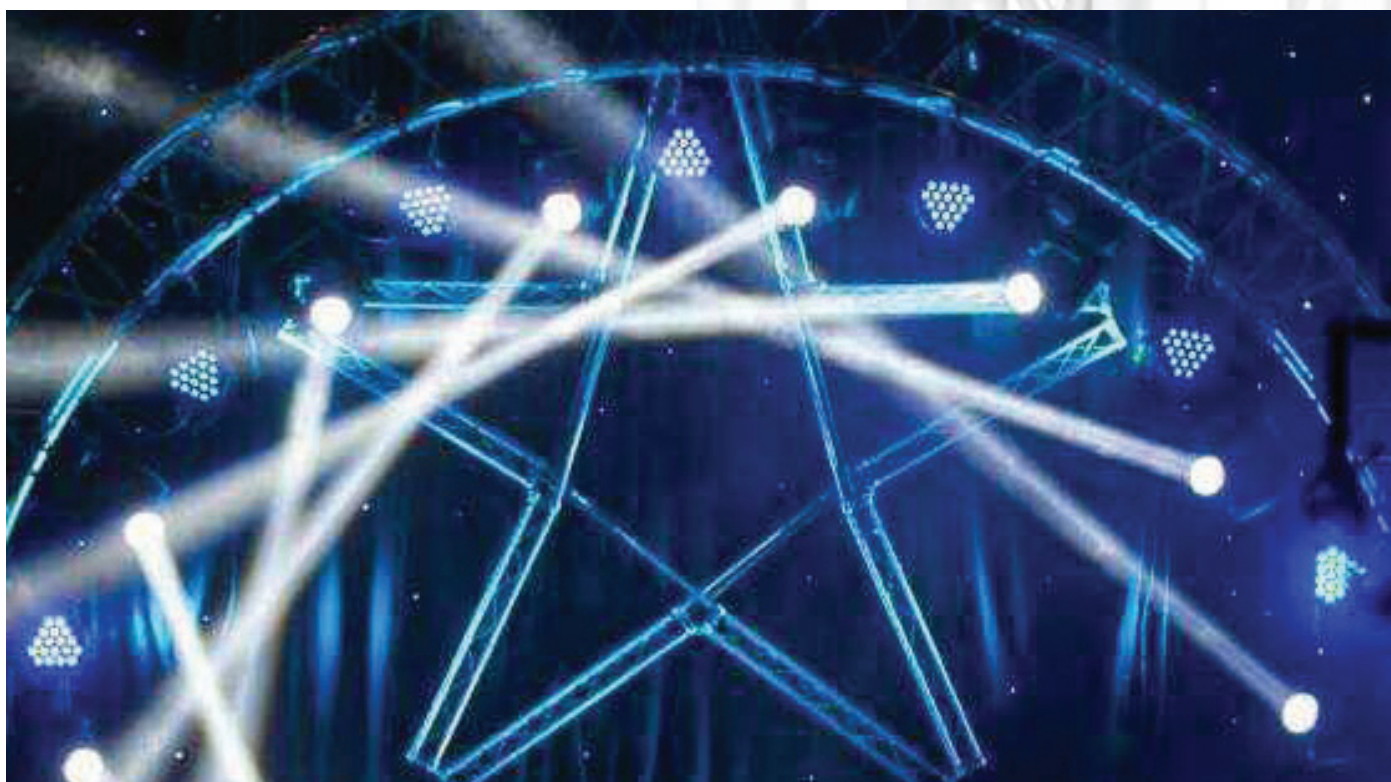

GALLERY





# TTECNO TRUSS



DIDAtronic Sas di Scardaoni P&C  
Via del Sersimone, 8/P  
05100 TERNI (TR)  
Tel. 0744 400420 - Fax 0744 461206  
email: [info@didatronic.it](mailto:info@didatronic.it)  
[www.tecnotruss.com](http://www.tecnotruss.com)

