



## EST-290

### DATI TECNICI:

Tubo principale: 50x2 mm

Diagonali: 20x2 mm

Alluminio: T6061

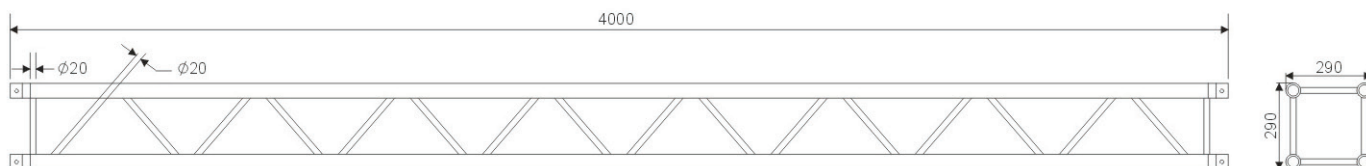
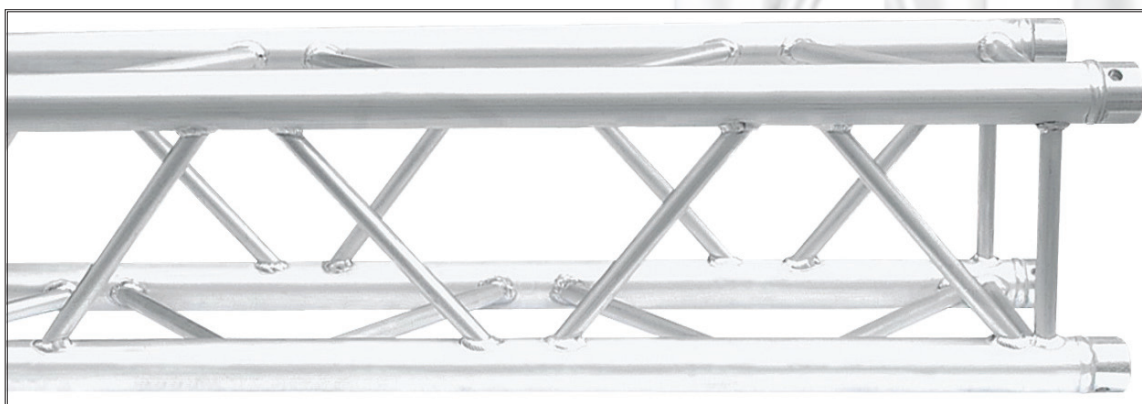

MODEL	DESCRIPTION	DIMENSIONS	DIAMETER/THICKNESS	LENGTH
EST-290-2	SQUARE TRUSS	290 x 290MM	50 x 2MM	500MM
EST-290-2	SQUARE TRUSS	290 x 290MM	50 x 2MM	1000MM
EST-290-2	SQUARE TRUSS	290 x 290MM	50 x 2MM	1500MM
EST-290-2	SQUARE TRUSS	290 x 290MM	50 x 2MM	2000MM
EST-290-2	SQUARE TRUSS	290 x 290MM	50 x 2MM	2500MM
EST-290-2	SQUARE TRUSS	290 x 290MM	50 x 2MM	3000MM

	2M	3M	4M	5M	6M	7M	8M	9M	10M	11M	12M	13M
<b>CENTRE POINT LOAD(KG)</b>	1311.1	1002.3	704.7	649.4	501.1	420.7	405.1	309	302.2	235.5	216.8	175
<b>DEFLECTION(MM)</b>	2	8	14	22	32	45	52	59	66	68	74	87
<b>SYMMETRICAL LOAD(KG)</b>	1473.6	1319.8	1125.4	1037.1	800.2	648.2	619	573	518.5	465.3	400	373.6
<b>DEFLECTION(MM)</b>	2	7	13	18	24	36	43	49	59	68	75	82