



EFT-290

DATI TECNICI:



Tubo principale: 50x2 mm

Diagonali: 20x2 mm

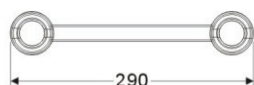
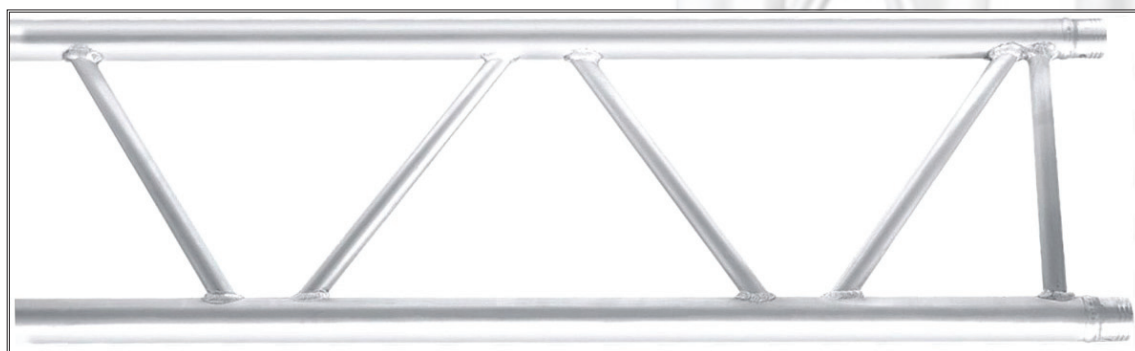
Alluminio: T6061



MODEL	DESCRIPTION	DIMENSIONS	DIAMETER/THICKNESS	LENGTH
EFT-290-2	FLAT TRUSS	290MM	50 x 2MM	500MM
EFT-290-2	FLAT TRUSS	290MM	50 x 2MM	1000MM
EFT-290-2	FLAT TRUSS	290MM	50 x 2MM	1500MM
EFT-290-2	FLAT TRUSS	290MM	50 x 2MM	2000MM
EFT-290-2	FLAT TRUSS	290MM	50 x 2MM	2500MM
EFT-290-2	FLAT TRUSS	290MM	50 x 2MM	3000MM

	1M	2M	3M	4M	5M	6M	7M	8M	9M	10M	11M	12M
 CENTRE POINT LOAD(KG)	1440	1190	1110	820	752	700	699	683	640	598	530	494.2
DEFLECTION(MM)	2.5	5.1	8.6	11.8	16.5	22.6	31.7	41.3	51.3	63.3	71.7	84.4
 SYMMETRICAL LOAD(KG)	1362(2)	1348(4)	1218(6)	1076(8)	1027(10)	960(12)	882(14)	840(16)	788(18)	740(20)	704(22)	672(24)
DEFLECTION(MM)	1.8	3.3	5.0	8.0	10.7	14.2	19.8	25.3	31.7	40.0	48.2	57.8